

"Full Service Cold Storage Panel Manufacturer Since 1953"

DADE ENGINEERING
From concept to completion

CUSTOM INDUSTRIAL PANELS

Temperature Controlled Warehouses & Facilities

Metal Insulated Panels | Refrigeration Parts & Supplies

CAD Design | Installation | Code Compliance | Maintenance | Repairs

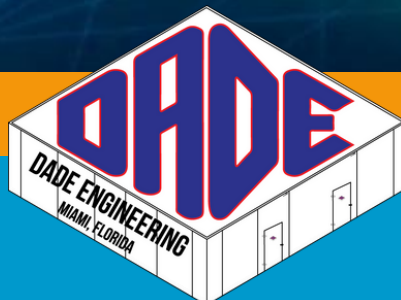

www.dadecoolers.com | 800-321-2112 | quotes@dadecoolers.com

7800 NW 37 Ave. Miami, FL 33147

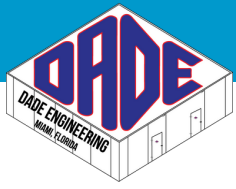

"Full Service Cold Storage Panel Manufacturer Since 1953"

COMMERCIAL & INDUSTRIAL INSULATED METAL PANELS FOR CUSTOM COLD STORAGE – WAREHOUSE - FACILITIES

Insulated metal panels specifically designed and constructed for use in the walls, ceilings, and floors of cold storage facilities and warehouses play a crucial role in creating and maintaining controlled environments for the storage of temperature-sensitive goods.

Dade Industrial & Commercial Panels are insulated metal panels composed steel skins laminated to a minimum of 1.6" polyisocyanurate foam core (minimum 2.3 pcf density). They are made to order with custom measurements that avoid waste and measure up to 39 ft. in length and usable width of 1000mm/39^{3/8}".

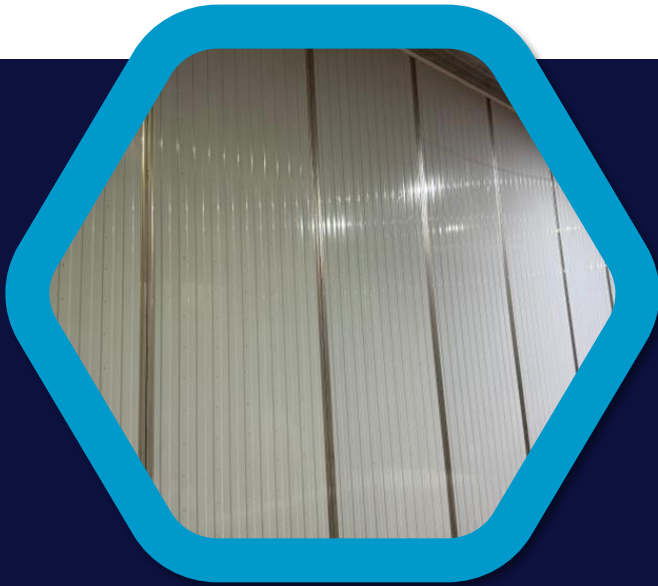

WARRANTY & CERTIFICATIONS

Warranties from 1 to 50 years, UL and UL7 approved, NSF and EISA certified and code compliant in Houston, Texas.



Ask about Our

WALK-IN COOLERS, FREEZERS & COMBINATION MODELS

Ceiling Suspension Systems | Doors | Windows | Hardware | Custom Projects



Our Website
www.dadecoolers.com



Our E-mail
quotes@dadecoolers.com



Contact Us
800-321-2112

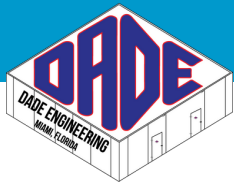

"Full Service Cold Storage Panel Manufacturer Since 1953"

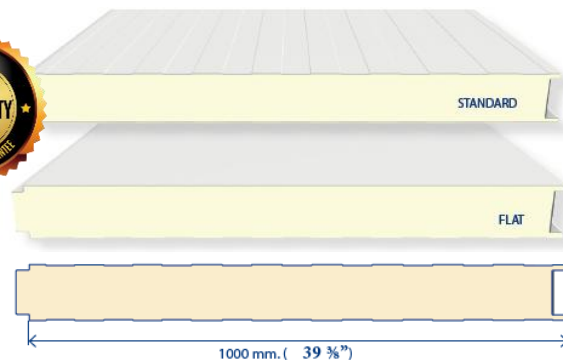

INSULATAED METAL PANELS

- Choose either a Standard, Semi-Smooth or Smooth Flat surface
- Maximum panel length is 1000 mm / 39^{3/8}"
- 1.6" Polyisocyanurate (PIR) insulation, R-value 35.5 and 50 year warranty

PANELS FEATURES

- **Customized:** Versatile for any configuration.
- **Quick Installation:** Easy to maintain, interior rounded concave corners does not collect debris
- **Relocatable:** Easily removable & configurable - wall, floor, corner and ceiling joints.
- **Cost-Efficient:** Made to measure, avoids waste with usable width of 1000mm / 39^{3/8}".
- **Durable:** Resistant to harsh environmental elements, panel thickness from 40mm/ 1^{9/16}" up to 150mm/6".
- **Aesthetics:** Choice of finishes, coatings and optional panel thickness.
- **Insulation:** High thermal insulation capacity, polyisocyanurate foam core, PIR, R-Value of 35.5.
- **Safe & Tested:** Mechanically strong, fire tested (ASTM E 84) and strength tested (STEM E 8) for optimal & safe performance.
- **Stability:** Dimensionally stable, up to 39 ft. in panel length and usable width of 1000mm/39^{3/8}".
- **Seal:** Water vapor tight, minimum 2.3 pcf density of 1.6" polyisocyanurate foam core (PIR) with an R-Value rating of 35.5.

CUSTOMIZED DOORS & OPTIONS

- High Speed Doors
- High Speed Doors with Heaters
- Bumper Accessories

Door Finish Options

- 26 Gauge Acrylume® Stucco Embossed Finish
- 24 Gauge Smooth Stainless Steel
- 26 Gauge Stucco Embossed White Pre-Painted Galvanized Steel

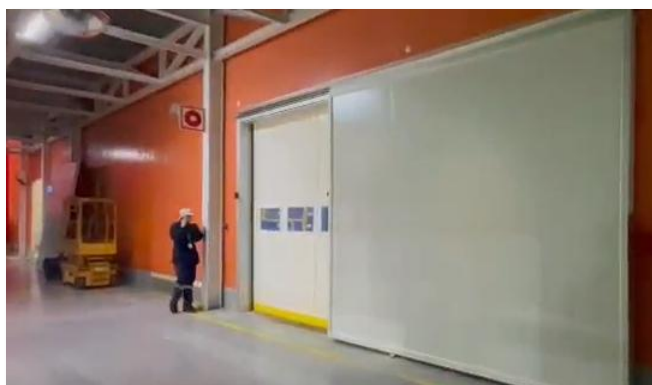
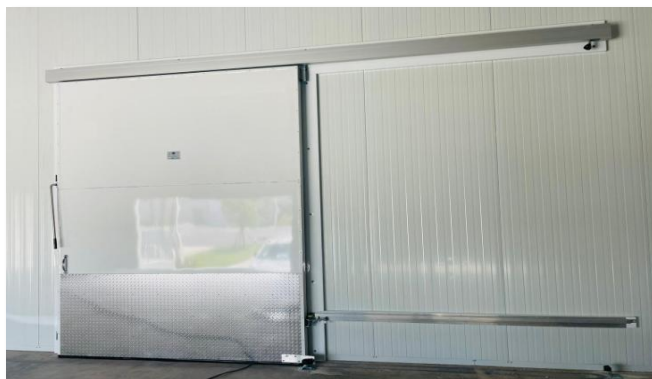

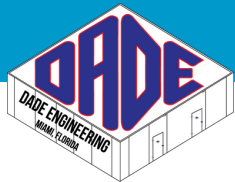

"Full Service Cold Storage Panel Manufacturer Since 1953"

INSULATED METAL PANEL TECHNICAL DATA

Metal Panel Data

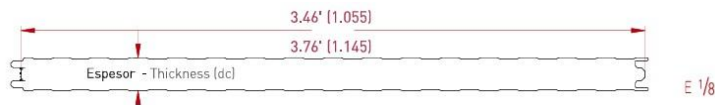

Thickness



Joint Detail

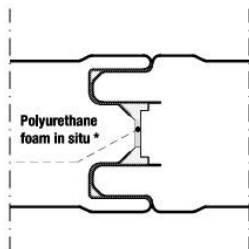

Thermal Conductivity

Panel nominal thickness	Thermal transmittance	Thermal resistance
d_c (mm-in)	U_{gs} [W/m ² K]	R Factor = (Hr-ft ² -°F)/BTU
60 (2.36'')	0,37	22,20
80 (3'')	0,28	26,60

Metal Panel Data



Thickness



Joint Detail

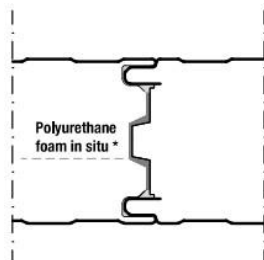
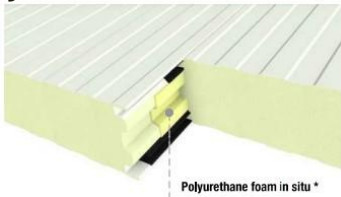

Thermal Conductivity

Panel nominal thickness	Thermal transmittance	Thermal resistance
d_c (mm-in)	U_{gs} [W/m ² K]	R Factor = (Hr-ft ² -°F)/BTU
100 (4'')	0,22	35,50
120 (5'')	0,18	44,35
150 (6'')	0,15	53,25
180 (7'')	0,12	62,15
200 (8'')	0,11	71,00
220 (9'')	0,10	79,90
240 (10'')	0,09	88,80

Technical Data (Key)

Reference	Value	Range
Width	3.46' (1.055 mm) 3.76' (1.145mm)	± 0.1"
Thickness [dc]	≤ 4" (100 mm) > 4" (100 mm)	± 0.1" ± 2 %
Lenght	min - 8'-2" max - 49'-2"	± 10 mm ± 10 %
Core density	40 Kg/m ³	± 10 %
Fire reaction	* Consult	

PANEL PROFILE & JOINT

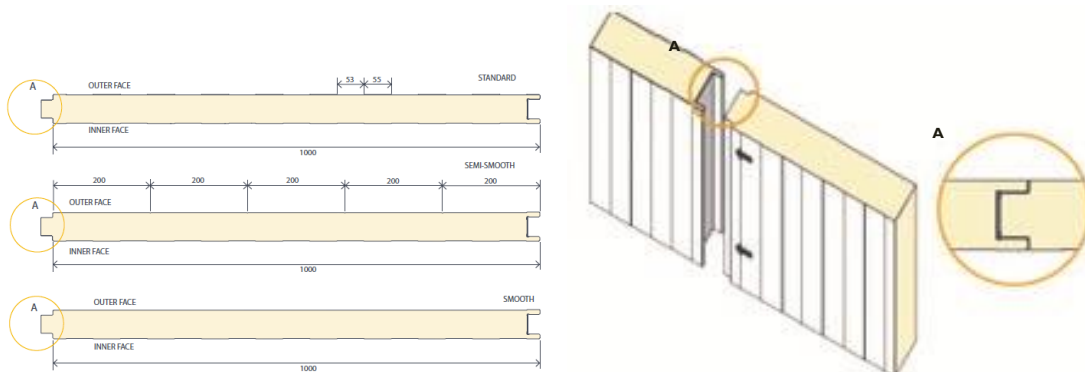

Our Website
www.dadecoolers.com



Our E-mail
quotes@dadecoolers.com



Contact Us
800-321-2112

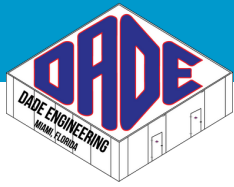

PANEL LOAD CAPACITY

Uniformly distributed overload
Support = 4"

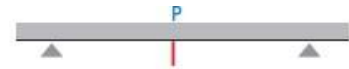

Panel thickness (mm - in)	Nominal steel thickness		Weight (kg/m ²)		Support = 4																							
	External (mm - cal)	Internal (mm - cal)			3m (9.84')		3,5m (11.48')		4m (13.12')		4,5m (14.76')		5m (16.4')		5,5m (18.04')		6m (19.69')		6,5m (21.33')		7m (22.97')							
			(kg/m ²)	(lb/ft ²)	(kg/m ²)	(lb/ft ²)	(kg/m ²)	(lb/ft ²)	(kg/m ²)	(lb/ft ²)	(kg/m ²)	(lb/ft ²)	(kg/m ²)	(lb/ft ²)	(kg/m ²)	(lb/ft ²)	(kg/m ²)	(lb/ft ²)	(kg/m ²)	(lb/ft ²)	(kg/m ²)	(lb/ft ²)						
60 (2.36")	0,50 (Cal 26)	0,50 (Cal 26)	9,9	2,0	140	28,7	100	20,5	75	15,4	60	12,3	50	10,2														
	0,60 (Cal 24)	0,50 (Cal 26)	10,8	2,2	150	30,7	110	22,5	80	16,4	65	13,3	55	11,3														
80 (3")	0,50 (Cal 26)	0,50 (Cal 26)	10,7	2,2	180	36,9	130	26,6	100	20,5	80	16,4	60	12,3														
	0,60 (Cal 24)	0,50 (Cal 26)	11,6	2,4	190	38,9	140	28,7	105	21,5	85	17,4	65	13,3														
100 (4")	0,50 (Cal 26)	0,50 (Cal 26)	12,8	2,6	215	44,0	155	31,7	120	24,6	95	19,5	75	15,4	60	12,3	50	10,2										
	0,60 (Cal 24)	0,50 (Cal 26)	13,8	2,8	225	46,1	165	33,8	125	25,6	100	20,5	80	16,4	65	13,3	55	11,3										
120 (5")	0,50 (Cal 26)	0,50 (Cal 26)	13,6	2,8	240	49,2	175	35,8	135	27,7	105	21,5	85	17,4	70	14,3	60	12,3	50	10,2								
	0,60 (Cal 24)	0,50 (Cal 26)	14,6	3,0	260	53,3	190	38,9	145	29,7	115	23,6	90	18,4	75	15,4	65	13,3	55	11,3								
150 (6")	0,50 (Cal 26)	0,50 (Cal 26)	14,8	3,0	275	56,3	205	42,0	155	31,7	120	24,6	100	20,5	80	16,4	65	13,3	55	11,3								
	0,60 (Cal 24)	0,50 (Cal 26)	15,8	3,2	295	60,4	215	44,0	165	33,8	130	26,6	105	21,5	85	17,4	70	14,3	60	12,3	50	10,2						
180 (7")	0,50 (Cal 26)	0,50 (Cal 26)	16,0	3,3	300	61,4	220	45,1	170	34,8	130	26,6	105	21,5	90	18,4	75	15,4	60	12,3	50	10,2						
	0,60 (Cal 24)	0,50 (Cal 26)	17,0	3,5	320	65,5	235	48,1	180	36,9	140	28,7	110	22,5	95	19,5	80	16,4	65	13,3	55	11,3						
200 (8")	0,50 (Cal 26)	0,50 (Cal 26)	16,8	3,4	310	63,5	225	46,1	175	35,8	135	27,7	110	22,5	90	18,4	75	15,4	65	13,3	55	11,3						
	0,60 (Cal 24)	0,50 (Cal 26)	17,8	3,6	330	67,6	240	49,2	185	37,9	145	29,7	115	23,6	95	19,5	80	16,4	70	14,3	60	12,3						
220 (9")	0,50 (Cal 26)	0,50 (Cal 26)	17,6	3,6	340	69,6	250	51,2	190	38,9	150	30,7	120	24,6	100	20,5	85	17,4	70	14,3	60	12,3						
	0,60 (Cal 24)	0,50 (Cal 26)	18,6	3,8	350	71,7	265	54,3	205	42,0	160	32,8	130	26,6	105	21,5	90	18,4	75	15,4	65	13,3						
240 (10")	0,50 (Cal 26)	0,50 (Cal 26)	18,4	3,8	350	71,7	275	56,3	210	43,0	165	33,8	135	27,7	110	22,5	95	19,5	80	16,4	65	13,3						
	0,60 (Cal 24)	0,50 (Cal 26)	19,4	4,0	355	72,7	290	59,4	225	46,1	175	35,8	140	28,7	115	23,6	100	20,5	85	17,4	70	14,3						

SCHEMATIC PANEL COMPONENTS

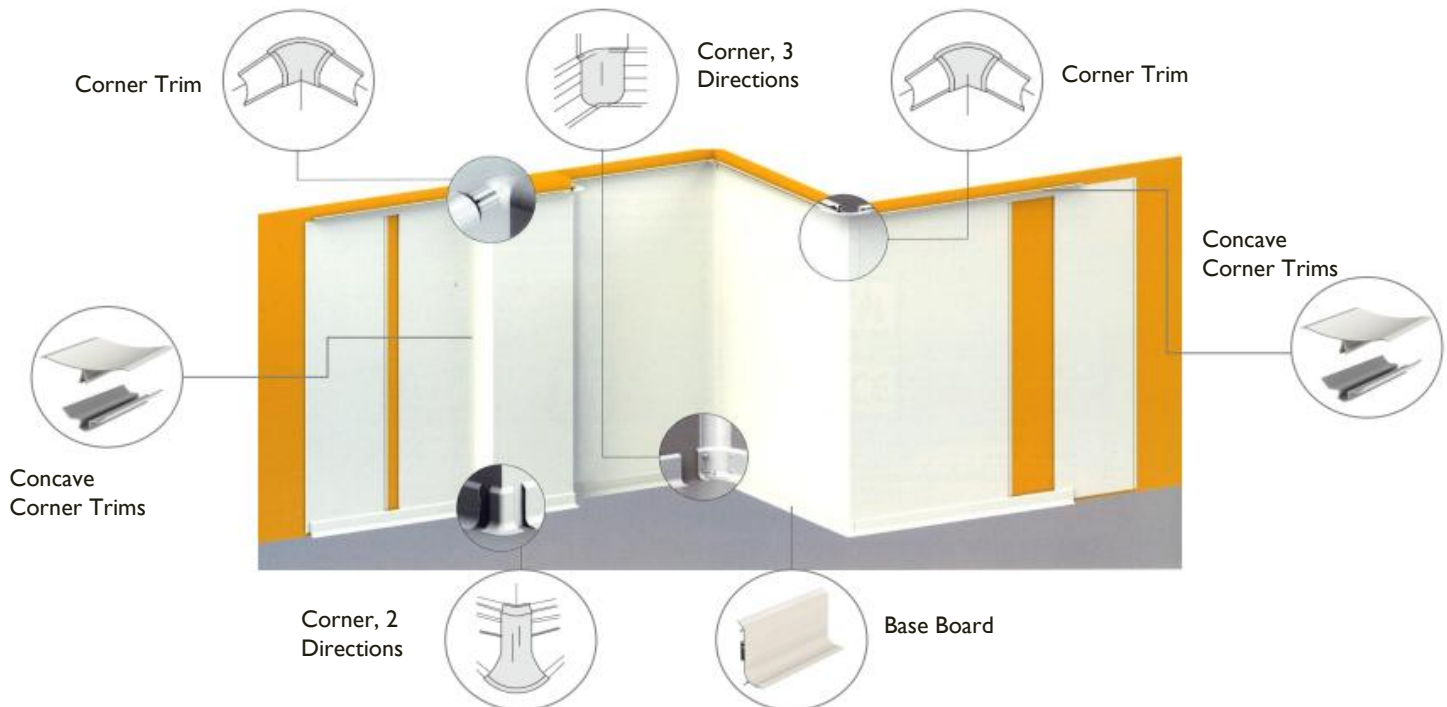

PANEL CORNER JOINTS

(Room temperature <0 degrees C)

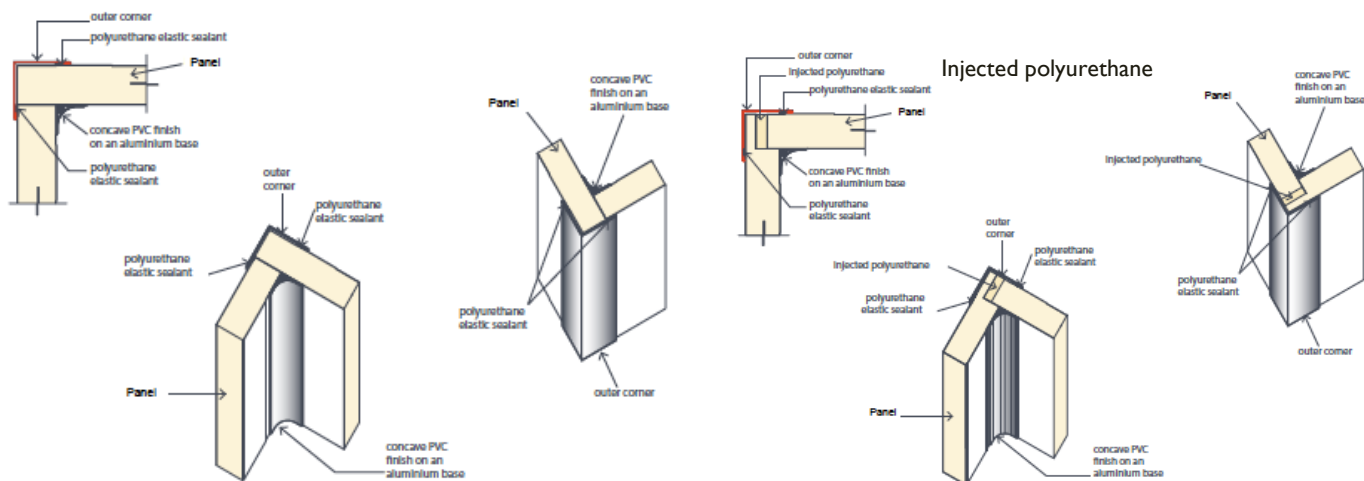

DOUBLE CORNER JOINT

(Room temperature <0 degrees C)

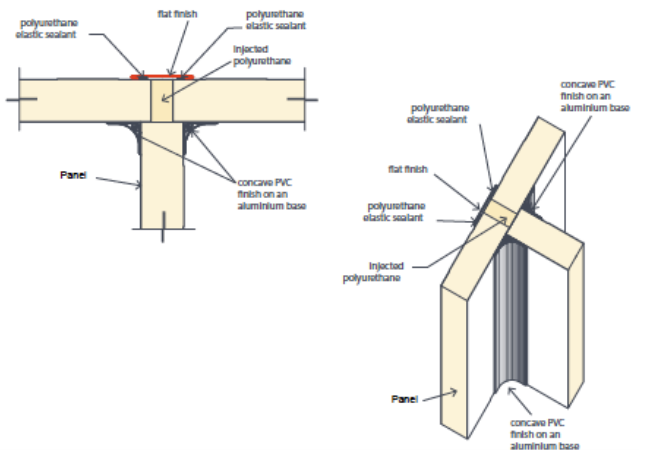

Injected polyurethane

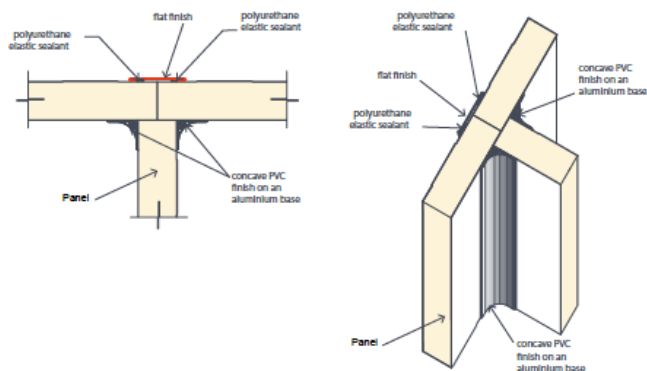

WALL-FLOOR JOINT

(Room temperature <0 degrees C)

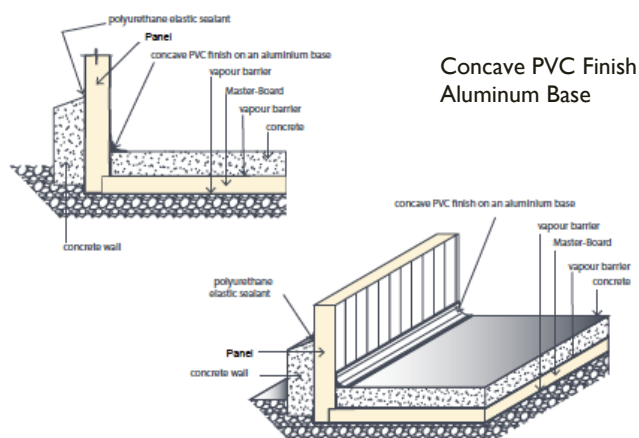

Concave PVC Finish
Aluminum Base

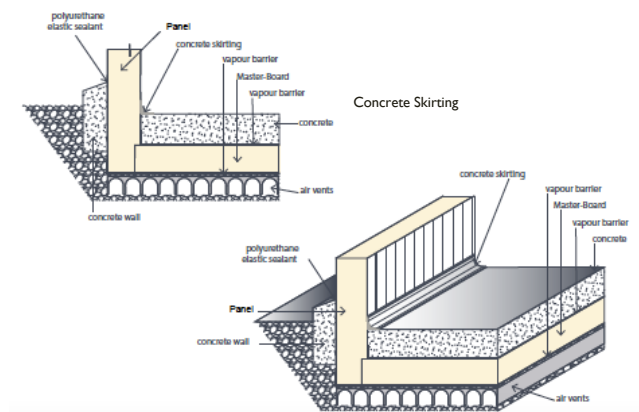

Concrete Skirting



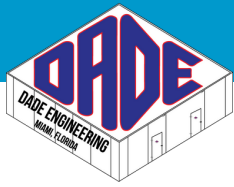

“Full Service Cold Storage Panel Manufacturer Since 1953”

PANEL CORNER & FLOOR MOLDING SYSTEMS

Base Board, PVC (Special Order)

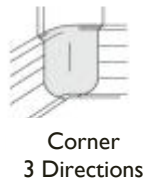

Coved Corner Trims, PVC with Aluminum Base

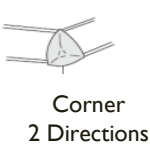

NSF Trims

3.5"
(In stock)

2.5"
(Special Order)

-15%



Aluminum Base

PVC

Wide
(In stock)

Trim
(Special Order)

Trim
(Special Order)

Solid
(Special Order)

-25%

-45%

-35%

CEILING LONGITUDINAL SUSPENSION

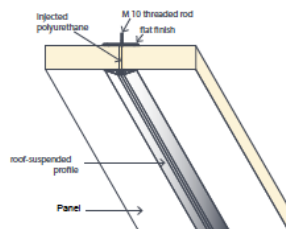
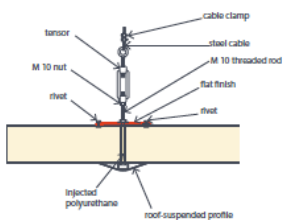
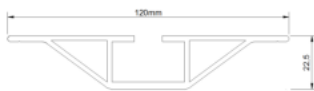
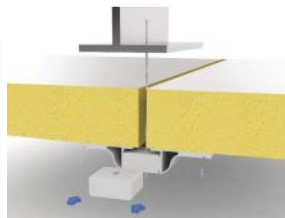

CEILING POINT SUSPENSION

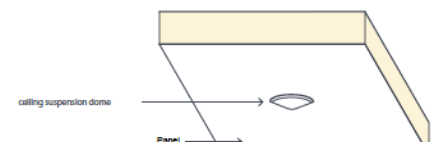
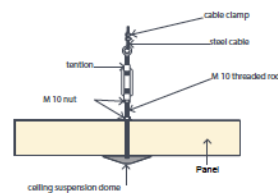
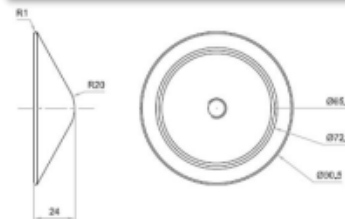
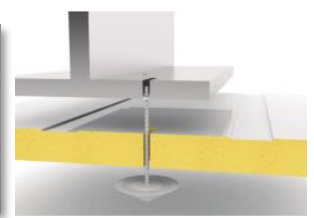

ABOUT US

Dade Coolers (Dade Engineering) has been manufacturing cold storage panels since 1953. Our product range includes **walk-in coolers and freezers, beer coolers/caves, store merchandisers, commercial refrigerators & freezers, cold storage rooms, and mortuary compartments.**



We use top-quality materials and the latest technology to ensure our products are of the highest quality and exceed local building codes.

Additionally, we are a **Heatcraft OEM distributor** and partner with top vendors such as **TurboAir, Copeland, Tecumseh and Weiss Instruments** for refrigeration parts.

OUR SERVICES

- Site surveys
- Project management
- Customized quotes
- Standard quotes in 24 hours
- Blueprints for permit submittals
- Customer service
- Engineering services
- CAD drawings
- Installation diagrams
- Quick Ship program
- Final permit inspections

OUR COMMITMENT

To manufacture the highest quality products for every application, delivering the perfect cold storage solution tailored to each customer's needs. From concept to completion, we stand by our dedication to excellence, reliability, and performance in every project."

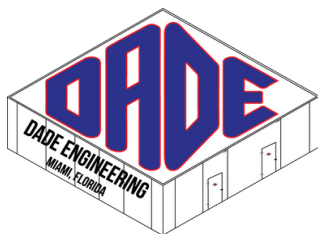

Turn-key solutions from design, to installation, and parts.
We have you covered from **concept to completion, and compliance.**



Contact Us
800-321-2112



Our Website
www.dadecoolers.com



Our E-mail
quotes@dadecoolers.com

Ask about our Quick Ship Program.
We ship nationwide.

CONNECT WITH DADE!



#DadeDifference